

Plan #9126 2560 Total S.F.

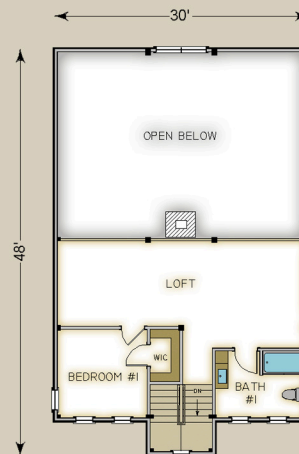

HABITAT FRAME NOTES:

FULL EXPOSURE WALL SYSTEM
 PLASTER AND BEAM MID-FLOOR
 BEAMED ROOF SYSTEM OVER LIVING, LOFT, BEDROOM #1, BATH #1 AND ENTRY PORCH
 CONVENTIONAL ROOF SYSTEM OVER REMAINDER
 FIR GIRDELS, RIDGES AND PURLINS
 9'-0" FOUNDATION
 8x8 PORCH POSTS

MAIN LEVEL

KITCHEN	20'-6" x 13'-0"
DINING	10'-6" x 9'-6"
PANTRY	5'-6" x 5'-0"
LIVING	29'-6" x 12'-6"
ENTRY	11'-0" x 8'-0"
MUDROOM	13'-6" x 5'-0"
LAV.	4'-6" x 6'-0"
HALL	13'-6" x 4'-0"
DEN	13'-6" x 14'-6"
MASTER BEDROOM	15'-6" x 11'-6"
WALK-IN CLOSET	5'-6" x 6'-0"
MASTER BATH	15'-6" x 5'-0"
PORCH	8'-6" x 8'-0"
SUN DECKS	BY OTHERS

UPPER LEVEL

LOFT	29'-6" x 10'-0"
BEDROOM #1	10'-6" x 10'-6"
WALK-IN CLOSET	3'-6" x 6'-0"
BATH #1	10'-6" x 8'-0"